

# CPV/CCV Ag

## General Information

**Purpose :** Detection of Canine Parvovirus and Coronavirus antigen

**Principle :** Immunochromatographic assay

**Specimen :** Canine feces

**Materials provided :**

- Anigen Rapid CPV/CCV test device
- Assay diluents tube
- Disposable swab
- Disposable dropper

**Special Features :**

- Simultaneous detection of CPV and CCV with one specimen preparation
- One-step testing procedure : Quick & Accurate
- High sensitivity and specificity



## Test Procedure

[ Proper sample amount collected by a swab ]

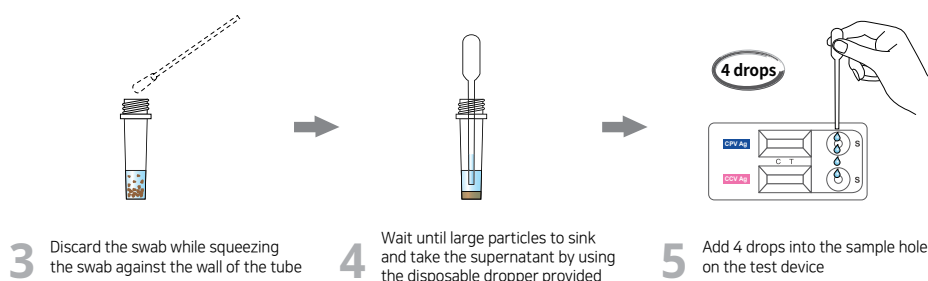
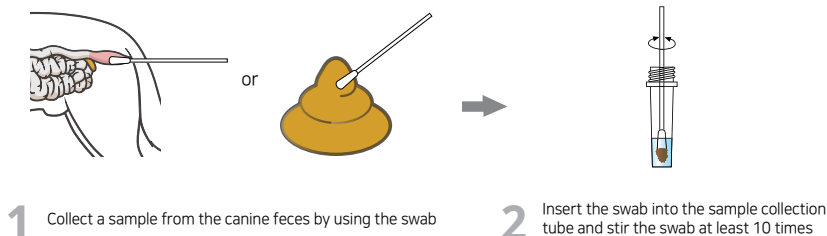
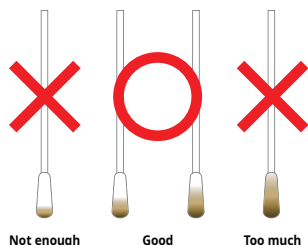

**Interpretation**

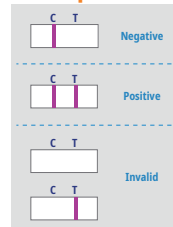

## Ordering Information

Cat. No.	Description	Type	Pack size
RC1105DD	CPV/CCV Ag	Dual Device	10 Tests/Kit