

Anigen Rapid CDV Ag

General Information

Purpose : Detection of Canine Distemper virus antigen

Principle : Immunochromatographic assay

Specimen : Conjunctiva (Recommended), urine, serum or plasma

Materials provided :

- Anigen Rapid CDV test device
- Assay diluents tube
- Disposable swab
- Disposable dropper

Special Features :

- One-step testing procedure : Quick & Accurate
- High sensitivity and specificity
 - Sensitivity : 98.8 % vs. Nested PCR
 - Specificity : 97.7 % vs. Nested PCR



Test Procedure

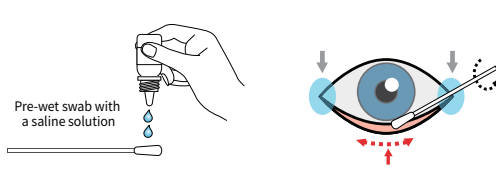

1 Collect conjunctiva sample from the 3rd eye lid (Red colored area)

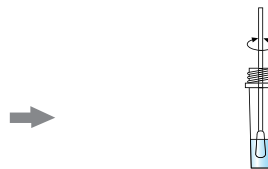

2 Insert the swab into the sample collection tube and stir the swab at least 10 times

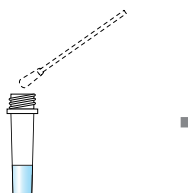

3 Discard the swab while squeezing the swab against the wall of the tube

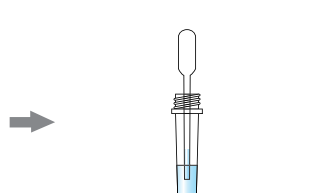

4 Take the supernatant by using the disposable dropper provided

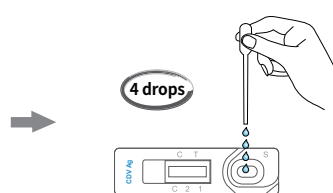

5 Add 4 drops into the sample hole on the test device

5-10 min.

Interpretation

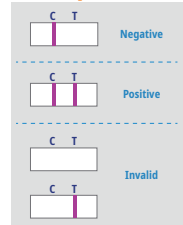

Ordering Information

Cat.No.	Description	Type	Pack size
RG1103DD	CDV Ag	Device	10 Tests/Kit