

# Anigen Rapid CPV Ag

## General Information

**Purpose :** Detection of Canine Parvovirus antigen

**Principle :** Immunochromatographic assay

**Specimen :** Canine feces

**Materials provided :**

- Anigen Rapid CPV test device
- Assay diluents tube
- Disposable swab
- Disposable dropper

**Special Features :**

- Detection of pathogenic CPV subtypes (CPV 2, 2a, 2b & 2c)
- One-step testing procedure : Quick & Accurate
- High sensitivity and specificity
  - Sensitivity : 100%
  - Specificity : 98.8%



## Test Procedure

[ Proper sample amount collected by a swab ]

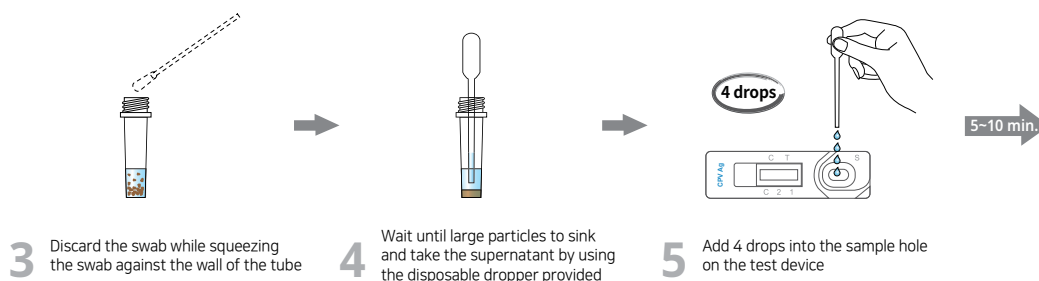
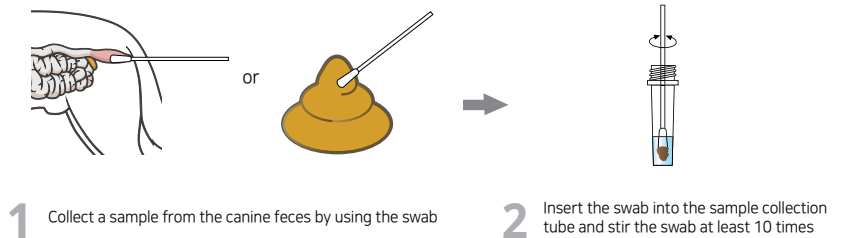
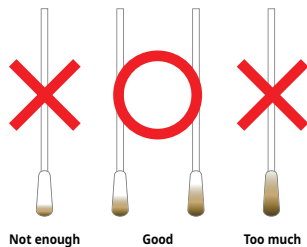

### Interpretation

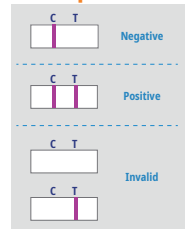

## Ordering Information

Cat. No.	Description	Type	Pack size
RG1101DD	CPV Ag	Device	10 Tests/Kit