

CPV/CCV/Giardia Ag

General Information

Purpose : Detection of Canine Parvovirus, Coronavirus and Giardia antigen

Principle : Immunochromatographic assay

Specimen : Canine feces

Materials provided :

- Anigen Rapid CPV/CCV/Giardia test device
- Assay diluents tube for CPV/CCV Ag (P)
- Assay diluents tube for Giardia Ag (G)
- Disposable swab
- Disposable dropper

Special Features :

- Simultaneous detection of CPV, CCV and Giardia
- One-step testing procedure : Quick & Accurate
- High sensitivity and specificity



Test Procedure

[Proper sample amount collected by a swab]

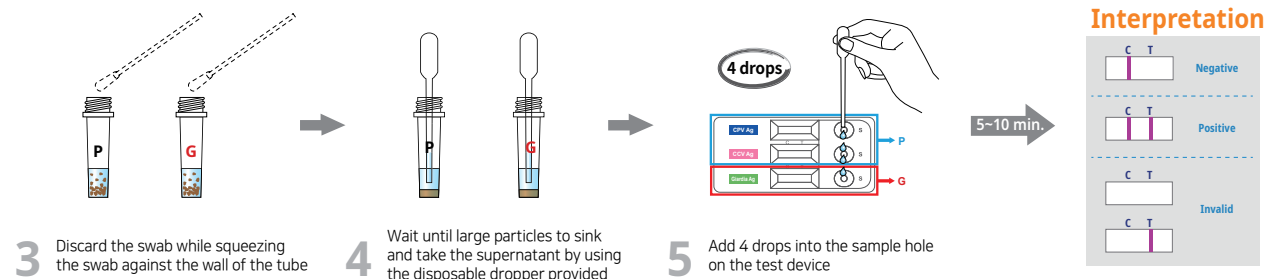
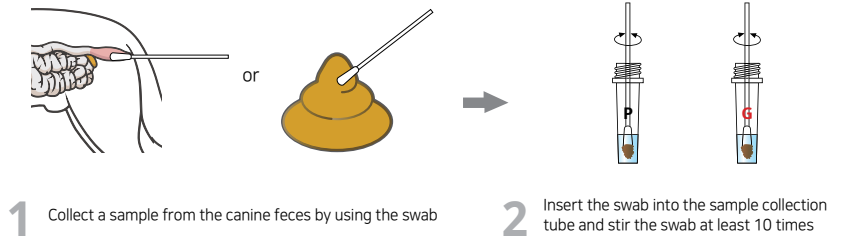
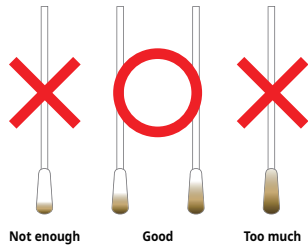

Ordering Information

Cat. No.	Description	Type	Pack size
RC1112DC	CPV/CCV/Giardia Ag	Quattro Device	5 Tests/Kit