

Serum Plasma (heparin) 1~30°C

Vcheck Canine CRP 2.0

Dilute sample Mix Measure



Use a 5 µl pipette to draw 5 µl of the sample and add into an assay diluent bottle. Close the bottle cap and shake for 5-6 times to mix thoroughly. Add 100 µl of the mixed sample to the sample well of the test device and press [START].

Normal	Equivocal	Abnormal
< 20 mg/L	20-30 mg/L	> 30 mg/L

Serum Plasma (heparin) 1~30°C

Vcheck Feline SAA 3.0

Dilute sample Mix Measure

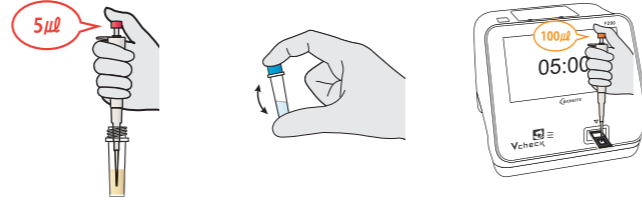

Use a 5 µl pipette to draw 5 µl of the sample and add into an assay diluent tube. Close the tube cap and shake for 5-6 times to mix thoroughly. Add 100 µl of the mixed sample to the sample well of the test device and press [START].

Normal	Equivocal	Abnormal
< 5 µg/ml	5-10 µg/ml	> 10 µg/ml

Serum 1~30°C

Vcheck cPL 2.0

Dilute sample Mix Measure



Use a 25 µl pipette to draw 25 µl of the serum and add to the assay diluent tube. Use a 100 µl pipette to mix the sample with diluent by pipetting 5-6 times. Add 100 µl of the mixed sample to the sample well of the test device and press [START].

Normal	Suspected	Pancreatitis
< 200 ng/ml	200-400 ng/ml	> 400 ng/ml

Serum Plasma (EDTA) 1~30°C

Vcheck fPL 2.0

Dilute sample Mix Measure

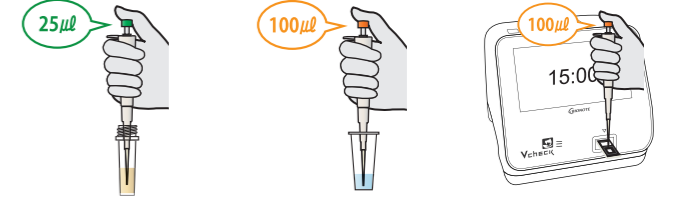

Use a 25 µl pipette to draw 25 µl of the sample and add into an assay diluent tube. Use a 100 µl pipette to mix the sample with diluent by pipetting 5-6 times. Add 100 µl of the mixed sample to the sample well of the test device and press [START].

Normal	Suspected	Pancreatitis
≤ 3.5 ng/ml	3.6-5.3 ng/ml	≥ 5.4 ng/ml

Serum 2~8°C

Vcheck T4

Dilute sample Mix & Incubate Measure

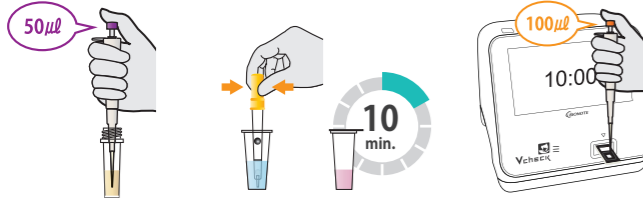

Use a 50 µl pipette to draw 50 µl of the serum and add to the assay diluent tube. Use a tablet pipette to mix over 8 times until the tablet is completely dissolved. Incubate the sample mixture at room temperature for 10 minutes. Add 100 µl of incubated sample to the sample well of the test device and press [START].

Dog	Low	Low normal	Normal	High	Therapeutic
	< 1.0 µg/dL	1.0-2.0	1.0-4.0	> 4	2.1-5.4
Cat	Low	Normal	Gray zone	Hyperthyroidism	
	< 0.8 µg/dL	0.8-4.7	2.3-4.7	> 4.7	

Serum 2~8°C

Vcheck cTSH

Dilute sample Mix Measure



Use a 100 µl pipette to draw 100 µl of the serum and add to the assay diluent tube. Use the same pipette to mix the sample with diluent by pipetting 5-6 times. Add 100 µl of the mixed sample to the sample well of the test device and press [START].

Normal	High
< 0.5 ng/mL	≥ 0.5 ng/mL

Plasma (sodium citrate) 2~8°C

Vcheck D-dimer

Sodium citrate Whole blood

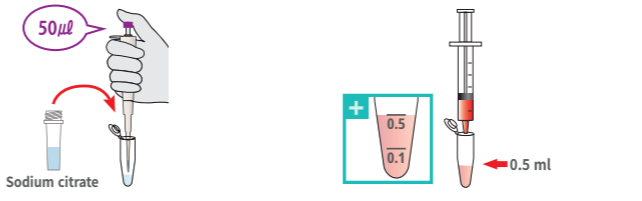

Use a 50 µl pipette to take 50 µl of sodium citrate and add it into a 1.5 ml tube. Add 450 µl of whole blood to the line of 0.5 ml. *Sodium citrate(50 µl):whole blood(450 µl)=1:9 ratio

Mix Centrifuge Dilute Sample

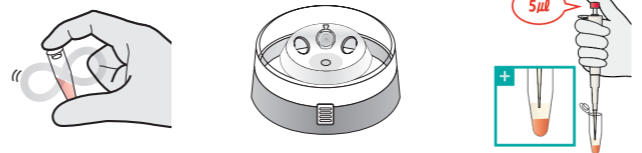

Mix the tube gently using a wrist snap making an 8-character shape. Centrifuge at 3,000 rpm for 15 min. Use a 5 µl pipette to draw 5 µl of plasma and add it to the assay diluent tube.

Mix Measure

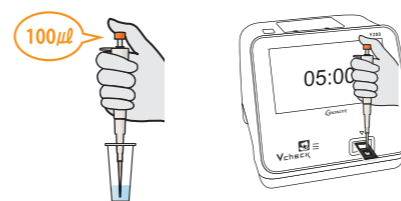

Use a 100 µl pipette to mix the sample with diluent by pipetting 5-6 times. Add all of the mixed sample to the sample well of the test device and press [START].

Normal	Abnormal (TED/DIC probable)
< 0.3 µg/ml	≥ 0.3 µg/ml

Serum Plasma (heparin) 2~8°C

Vcheck SDMA

Sample Pretreatment Mix

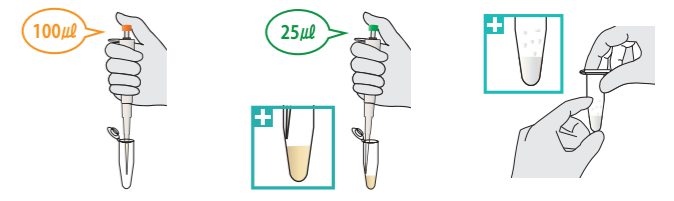

Use a 100 µl pipette to draw 100 µl of the sample and add to a 1.5 ml tube. Use a 25 µl pipette to draw 25 µl of the Pretreatment Buffer and add it to the 1.5 ml tube. Mix well using a vortex mixer. If not, tap with fingers 6-8 times. *Ensure that the sample and pretreatment buffer are well mixed to form white sediment. *The end of the pipette tip should be applied onto the inner wall of the tube to prevent the pipette tip from clogging.

Centrifuge Collect supernatant Assay diluent

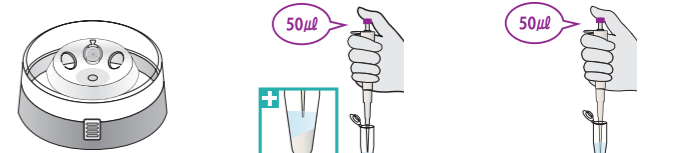

Centrifuge at 6,000 x g for 5 min within 10 seconds from the mixing stage. Collect 50 µl of the separated supernatant and transfer to a new 1.5 ml tube. Collect 50 µl of the assay diluent and add it to the tube containing the supernatant. Mix well 5-6 times. * (10,000 RPM for 5 min with the centrifuge provided by Bionote) * Be careful not to bring the sediments at the bottom.

Mix Measure

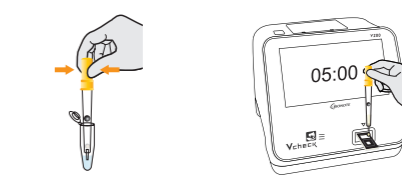

Within one minute, use a disposable pipette to mix well until the white tablet dissolves completely. Add all of the mixed sample into the sample hole of the test device and press [START].

* Please place each sample and packaged kit component at room temperature (15~30°C) 30 minutes before use. Warming them up by hand or any other improper elevation of the temperature should be avoided as it may generate invalid results.

Normal	Suspected	Kidney disease probable
≤ 14 µg/dL	14.1 - 19.9 µg/dL	≥ 20 µg/dL

Serum 2~8°C

Vcheck cCortisol

Dilute sample Mix & Incubate Measure

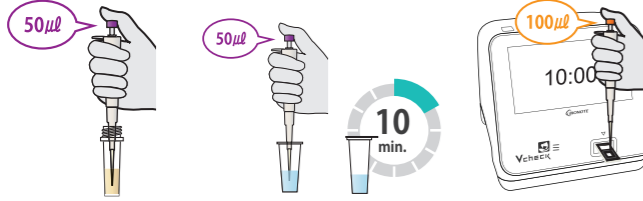

Use a 50 µl pipette to draw 50 µl of the serum and add to the assay diluent tube. Use the same pipette to mix the sample with diluent by pipetting 5-6 times. Incubate the sample mixture at room temperature for 10 minutes. Add 100 µl of incubated sample to the sample well of the test device and press [START].

* Please refer to the product Instructions for Use to determine the results of ACTH ST, LDDST, or HDDST.

Serum 2~8°C

Vcheck cProgesterone

Dilute sample Mix Measure

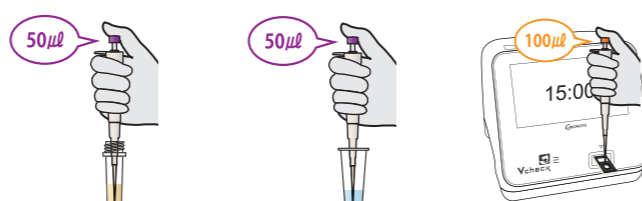



Use a 50 µl pipette to draw 50 µl of the serum and add to the assay diluent tube. Use the same pipette to mix the sample with diluent by pipetting 5-6 times. Add 100 µl of the mixed sample to the sample well of the test device and press [START].

Anestrus or proestrus	Pre-LH surge	LH surge	Post-LH surge	Ovulation	Post-ovulation
< 1.0 ng/mL	1.0 - 1.99	2.0 - 2.99	3.0 - 4.99	5.0 - 12.0	> 12.0

Serum 1~30°C

Serum 2~8°C

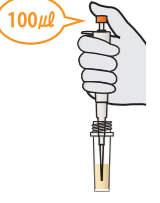
Vcheck Feline NT-proBNP

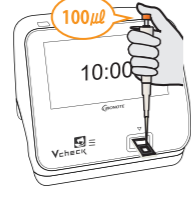
Dilute sample	Mix	Measure
		
Use a 100 µl pipette to draw 100 µl of the serum and add to the assay diluent tube.	Use the same pipette to mix the sample with diluent by pipetting 5-6 times.	Add 100 µl of the mixed sample to the sample well of the test device and press [START].

Normal	Abnormal
< 100 pmol/L	≥ 100 pmol/L

Vcheck Canine NT-proBNP

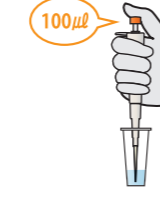
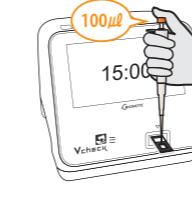

Dilute sample	Mix	Measure
		
Use a 100 µl pipette to draw 100 µl of the serum and add to the assay diluent tube.	Use the same pipette to mix the sample with diluent by pipetting 5-6 times.	Add 100 µl of the mixed sample to the sample well of the test device and press [START].

Normal	Suspected	Abnormal
< 900 pmol/L	900 - 1,800 pmol/L	> 1,800 pmol/L

Serum 1~30°C

Serum 1~30°C

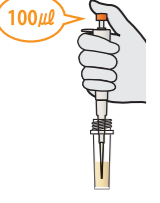
Vcheck Feline TnI

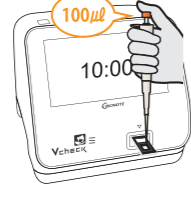
Dilute sample	Mix	Measure
		
Use a 100 µl pipette to draw 100 µl of the serum and add to the assay diluent tube.	Use the same pipette to mix the sample with diluent by pipetting 5-6 times.	Add 100 µl of the mixed sample to the sample well of the test device and press [START].

Normal	Suspected	Abnormal
< 0.18 ng/ml	0.18 - 0.28 ng/ml	> 0.28 ng/ml



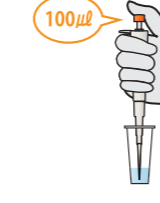
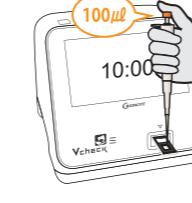

Vcheck Canine TnI

Dilute sample	Mix	Measure
		
Use a 100 µl pipette to draw 100 µl of the serum and add to the assay diluent tube.	Use the same pipette to mix the sample with diluent by pipetting 5-6 times.	Add 100 µl of the mixed sample to the sample well of the test device and press [START].

Normal	Suspected	Abnormal
< 0.1 ng/ml	0.1 - 0.2 ng/ml	> 0.2 ng/ml

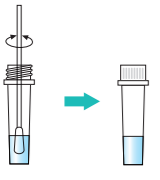
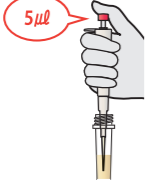
2~30°C

Vcheck Ag, Ab

Dilute sample		Measure	Add sample	Incubate	Measure
Ag	Ab Serum Plasma	[STANDARD TEST]	[READ ONLY]	10 min.	
					
Insert a swab used for collecting sample into the assay diluent tube. Mix the swab and wait for 1 minute for the mixture to settle down.	Use a 5 µl pipette to draw 5 µl of the sample and add into an assay diluent tube.	Use a 100 µl pipette to mix well 5-6 times and add 100 µl of the mixed sample to the sample well and press [START].	Use a 100 µl pipette to mix well 5-6 times and add 100 µl of the mixed sample to the sample well.	Leave the test device for 10 minutes. Note that the device should not be left for more than 13 minutes.	Insert the test device into the V200 Analyzer.

Ab Titer	Poor immune status	Protective immunity
	< Titer 3	≥ Titer 3